

# SCHEMATIC LAYOUT PLAN

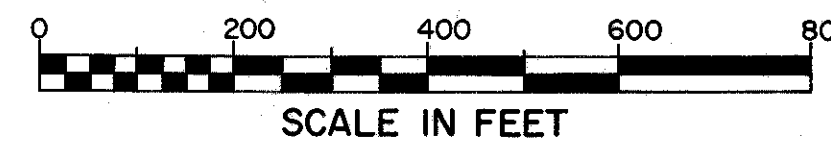

FED. RD. DIVISION	STATE	PROJECT
2	OHIO	

3  
665

CUYAHOGA COUNTY  
CUY-71-10.44

CO. RD. No. 189

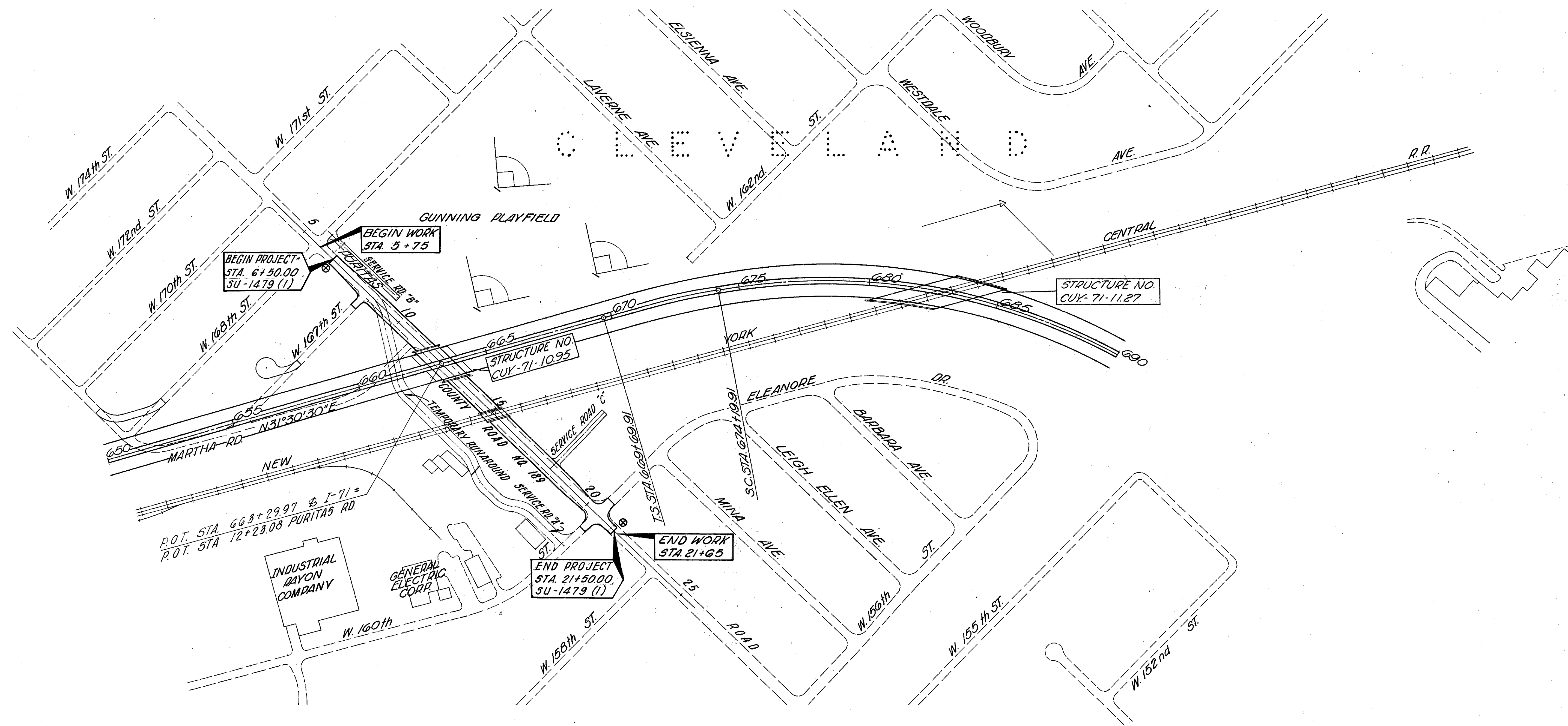

## CURVE DATA

PI. STA. 685+52.93	Ls = 450.00'
$\Delta = 61^{\circ}13'10''$ RT.	Os = 05^{\circ}37'30''
Lc = 49^{\circ}58'10'' RT.	P = 3.68'
Dc = 02^{\circ}30'00''	K = 224.93'
Rc = 2291.83'	LT = 300.15'
Tc = 1067.95'	ST = 150.14'
Lc = 1993.78'	Ts = 1583.01'
Ec = 236.61'	Es = 375.33'

⊗ DENOTES F.A.C.I. SIGN

CUYAHOGA COUNTY  
CUY-71-10.44  
CO. RD. No. 189

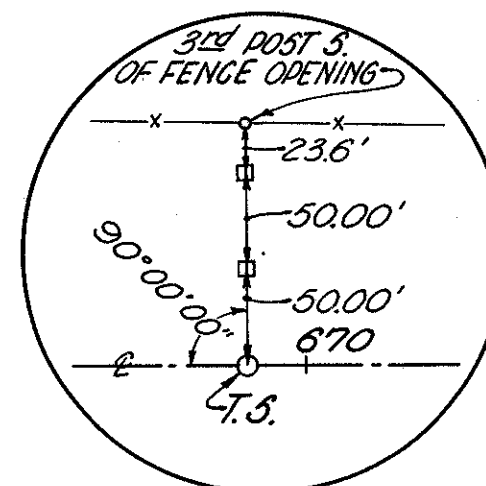
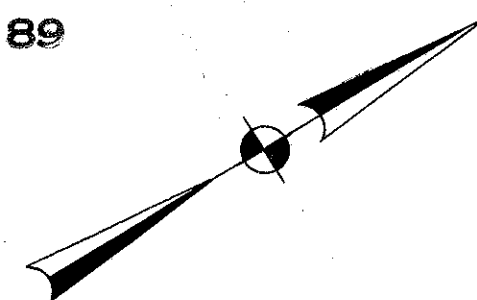

REF. T.S.  
STA. 669+69.91

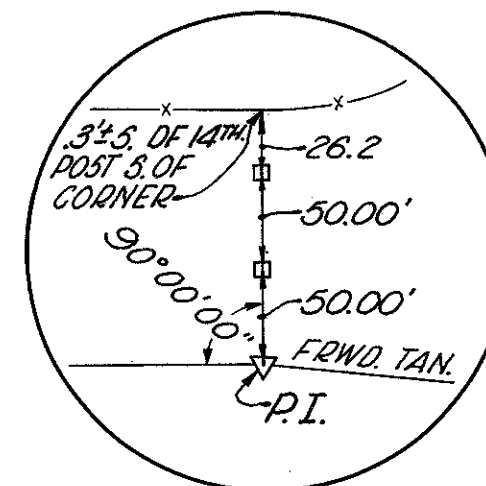

REF. P.I.  
STA. 672+70.06

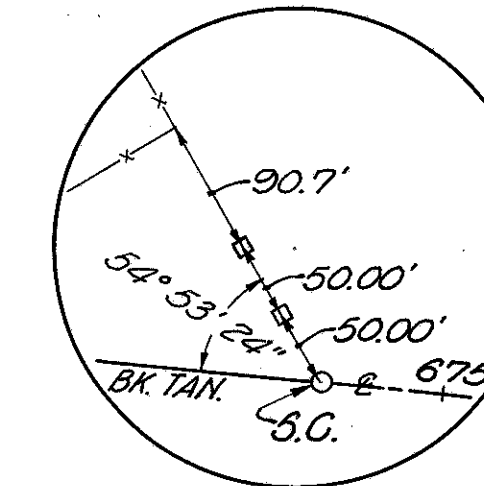

REF. S.C.  
STA. 674+19.91

**LEGEND**

	SIDEWALK REMOVAL
	PAVEMENT REMOVAL

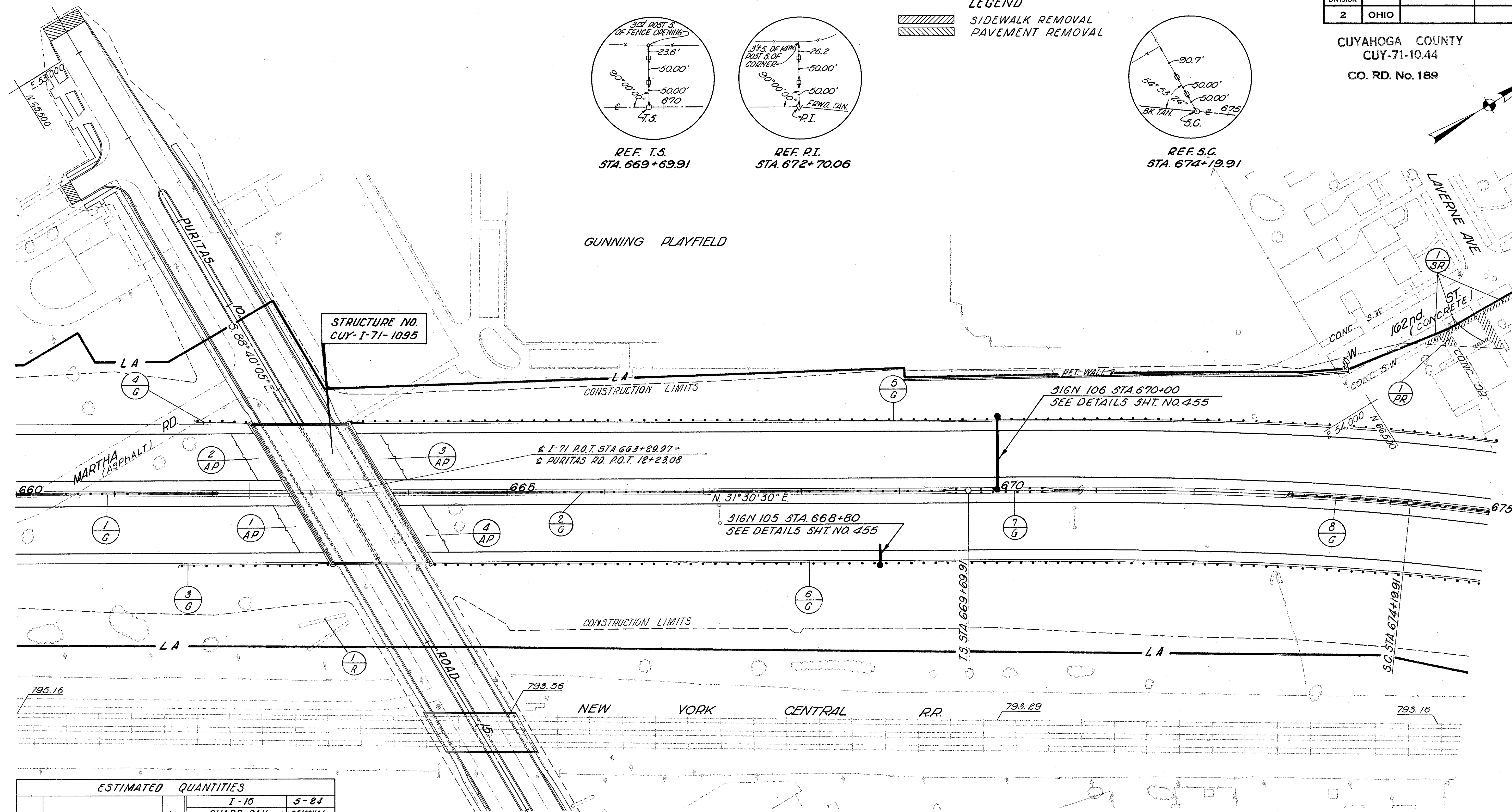

ESTIMATED QUANTITIES					
REF NO.	STATION TO STATION.	SIDE	I - 15		5 - 24
			GUARD RAIL		REMOVAL OF EXIST. STRUCTURE
			BARRIER TYPE DEEP	STANDARD TYPE DEEP	
			LI.N. FT	LI.N. FT	LUMP
1-G	660+00 - 662+77.04	E	277.04		
2-G	663+02.90 - 669+43.75	E	560.85		
3-G	661+68 - 663+13	RT		150	
4-G	661+65 - 662+35	LT		50	
5-G	663+43 - 675+00	LT		1157	
6-G	664+27 - 675+00	RT		1073	
7-G	669+43.75 - 670+56.25	L & R		225	
8-G	670+56.25 - 675+00	E	443.75		
1-R	PURITAS RD. 13+40	RT.			LUMP
	TOTAL		1281.64	2655	LUMP

**BENCH MARK**  
Spike in S.E. side of Tele-  
phone Pole, I.O'Rt. Sta.  
663+00 ~ Elev = 787.84

ESTIMATED QUANTITIES						
REF NO.	STATION TO STATION.	SIDE	I - 7	E - 8		
			APPROACH SLABS	REMOVAL & DISPOSAL OF EXISTING		
				PAV'T	CURB	3 IN.
			S.Y.	SQ. YD	LIN. FT.	SQ. FT.
1-AP	662+52.04 ~ 662+77.04	RT	133			
2-AP	662+52.04 ~ 662+77.04	LT	133			
3-AP	663+82.90 ~ 664+07.90	LT	133			
4-AP	663+82.90 ~ 664+07.90	RT	133			
1-PR	W 162 <sup>old</sup> ST.			140	40	
1-SR	W 162 <sup>old</sup> ST					495
	TOTAL		532	140	40	495

NOTE:  
FOR DRAINAGE PLAN, SEE SHEET NO. 288.  
FOR PURITAS RD. PLAN & PROFILE, SEE SHEET NO. 213 & 218.  
FOR I - 71 PROFILE, SEE SHEET NO. 50.  
FOR DETAIL OF MEDIAN GUARD RAIL AT SIGN POSTS:  
SEE SHEET NO. 352.

**BENCH MARK**  
Chiseled on S.E. Cor. Head-  
wall, 78.5' Rt. Sta. 672. +97  
Elev = 787.67

I-7/ PLAN~ STA. 660 + 00 TO STA. 675 + 00



CUYAHOGA COUNTY  
CUY-71-10.44  
CO. RD. No. 189

**CURVE DATA**  
 P.I. STA. 685+52.93       $L_s = 450.00'$   
 $\Delta = 61^\circ 13' 10''$  RT.       $\Delta_s = 05^\circ 37' 30''$   
 $\Delta_c = 49^\circ 58' 10''$  RT.       $P = 3.68'$   
 $R_c = 2291.83'$        $K = 224.93'$   
 $T_c = 1067.95'$        $LT = 300.15'$   
 $L_c = 1998.75'$        $ST = 150.14'$   
 $E_c = 236.61'$        $TS = 1583.01'$   
                               $ES = 375.33'$

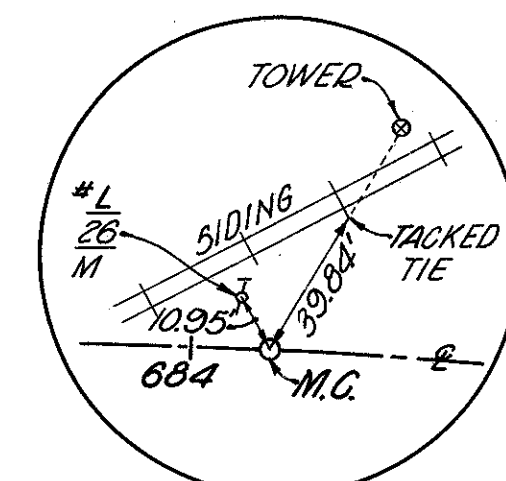

REF. M.G.  
STA. 684+19.30

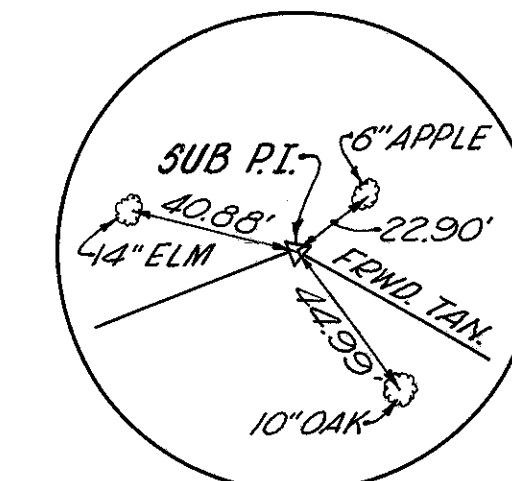

REF. SUB PI.  
STA. 684+87.86

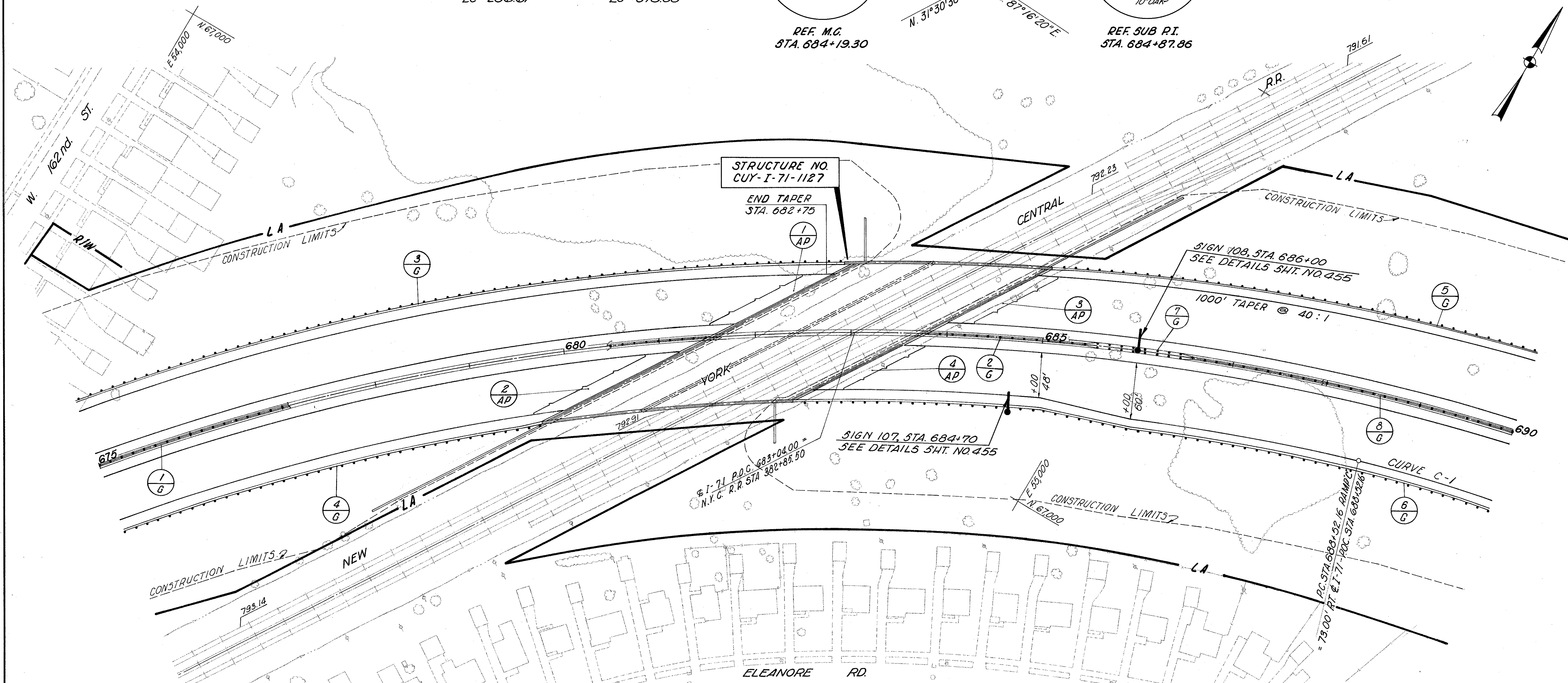

ESTIMATED QUANTITIES				
REF. NO.	STATION TO STATION	SIDE	I - 15	
			GUARD RAIL	BARRIER STANDARD
			TYPE	TYPE
			DEEP	DEEP
			LIN. FT.	LIN. FT.
1-G	675+00 ~ 681+52.93	Q	652.93	
2-G	683+78.31 ~ 685+43.75	Q	165.44	
3-G	675+00 ~ 682+93	LT		793
4-G	675+00 ~ 679+64.5	RT		464.5
5-G	685+04 ~ 690+00	LT		496
6-G	682+39 ~ 690+00	RT		761
7-G	685+43.75 ~ 686+56.25	L&R		225
8-G	686+56.25 ~ 690+00	Q	343.75	
TOTAL			1162.12	2739.5

ESTIMATED QUANTITIES				
REF. NO.	STATION TO STATION	SIDE	I - 7	
			APPROACH	SLABS
			S.Y.	
1-AP	681+27.94 ~ 681+52.94	LT	133	
2-AP	681+27.94 ~ 681+52.94	RT	133	
3-AP	683+78.98 ~ 684+03.98	LT	147	
4-AP	683+78.98 ~ 684+03.98	RT	133	
TOTAL			546	

**BENCH MARK**  
 Chiseled in N.E. Cor. Conc.  
 Base to Tower, 60' Lt. Sta.  
 684+54 ~ Elev. = 790.05

NOTE:  
 FOR DRAINAGE PLAN, SEE SHEET NO. 289.  
 FOR I-71 PROFILE, SEE SHEET NO. 51.  
 FOR DETAIL OF MEDIAN GUARD RAIL AT SIGN POSTS-  
 SEE SHEET NO. 352.

113  
665

CUYAHOGA COUNTY  
CUY-71-10.44  
CO. RD. No. 189

DESCRIPTION	BY	DATE	CHECKED	DATE
DESIGNED	BY	DATE	BY	DATE
TEMPERATURE	BY	DATE	BY	DATE
STATIONING	BY	DATE	BY	DATE
STATIONING	BY	DATE	BY	DATE

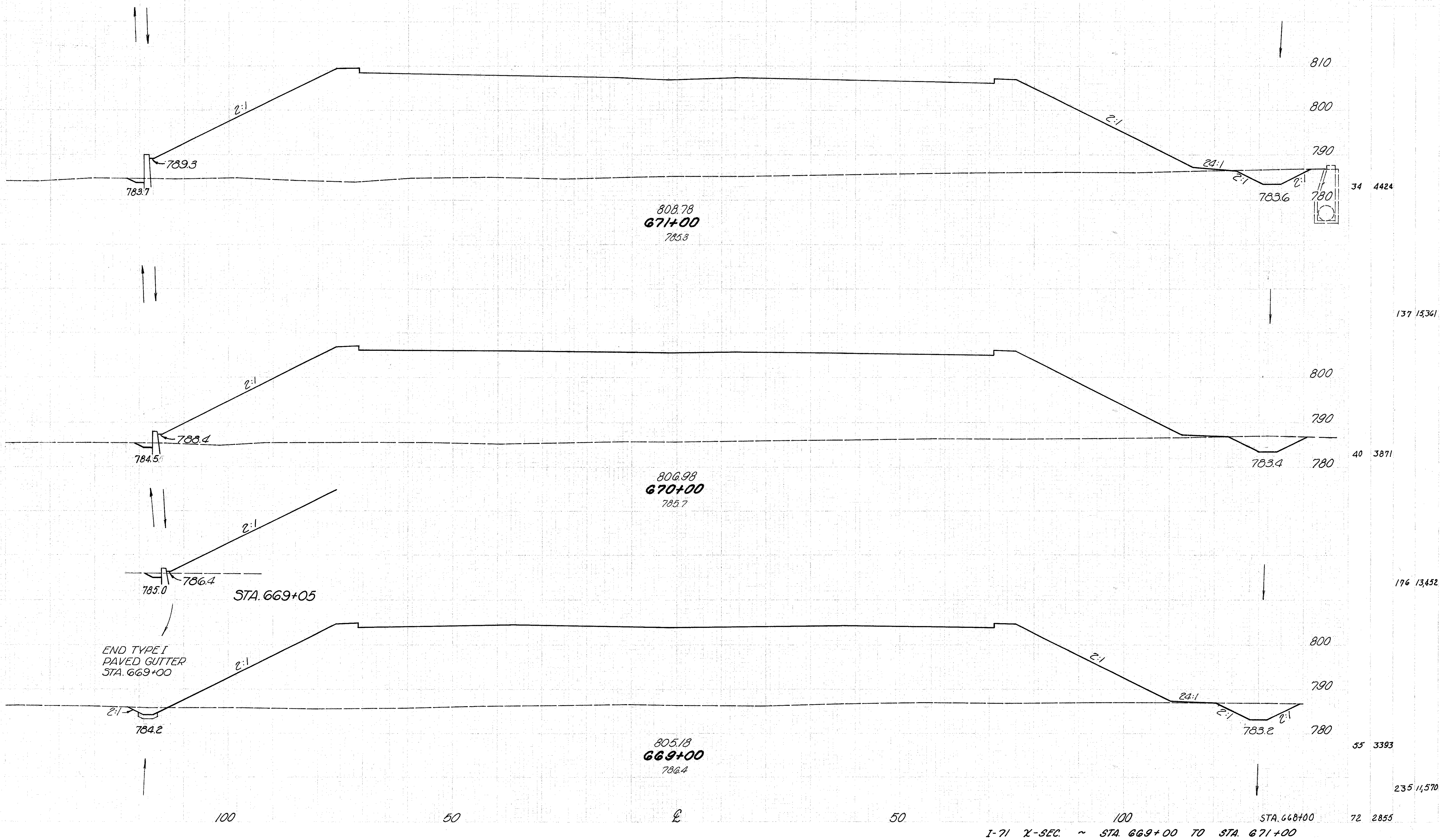

I-71 X-SEC. ~ STA. 669+00 TO STA. 671+00



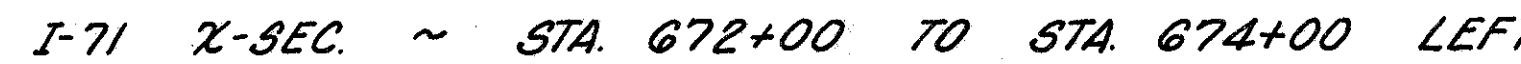

CUYAHOGA COUNTY  
CUY-71-10.44  
CO. RD. No. 189

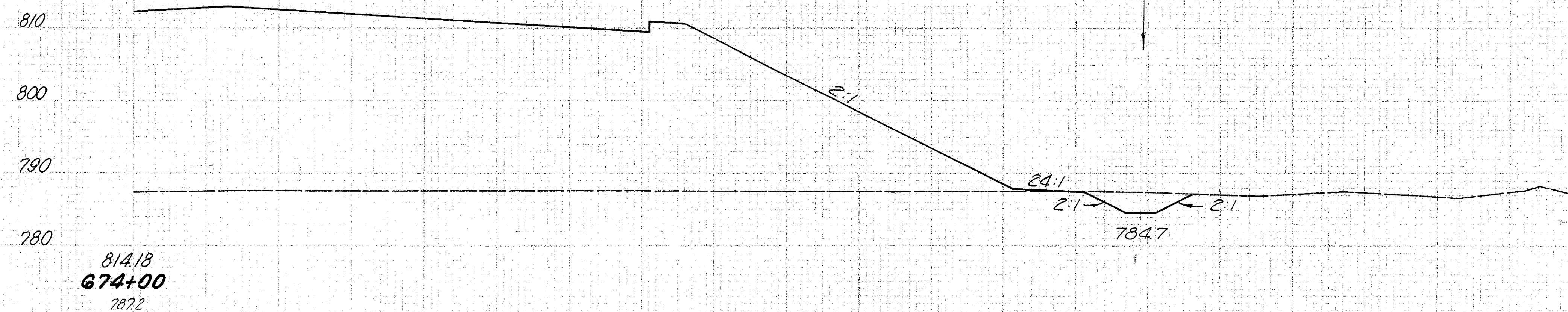

LT 37 2949  
RT 28 2380  
65 5329

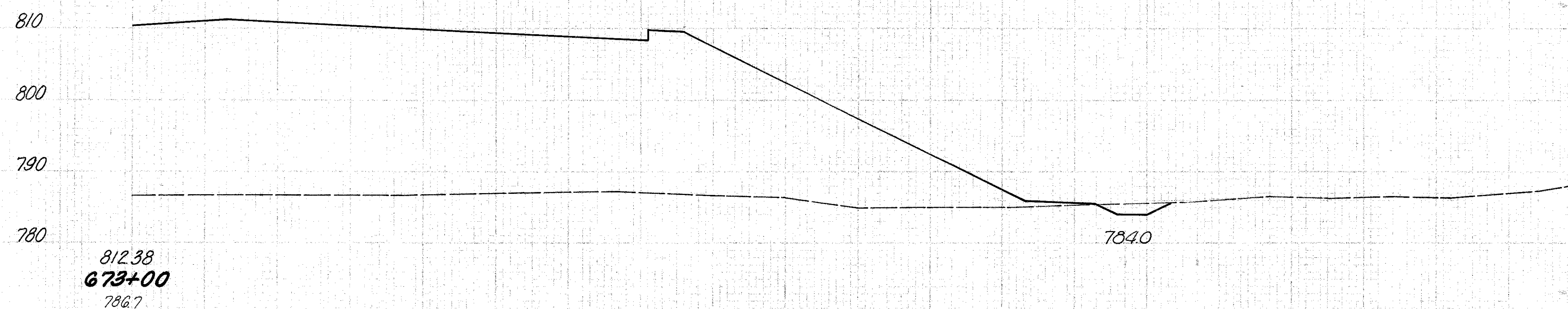

LT 25 2742  
RT 13 2340  
38 5082

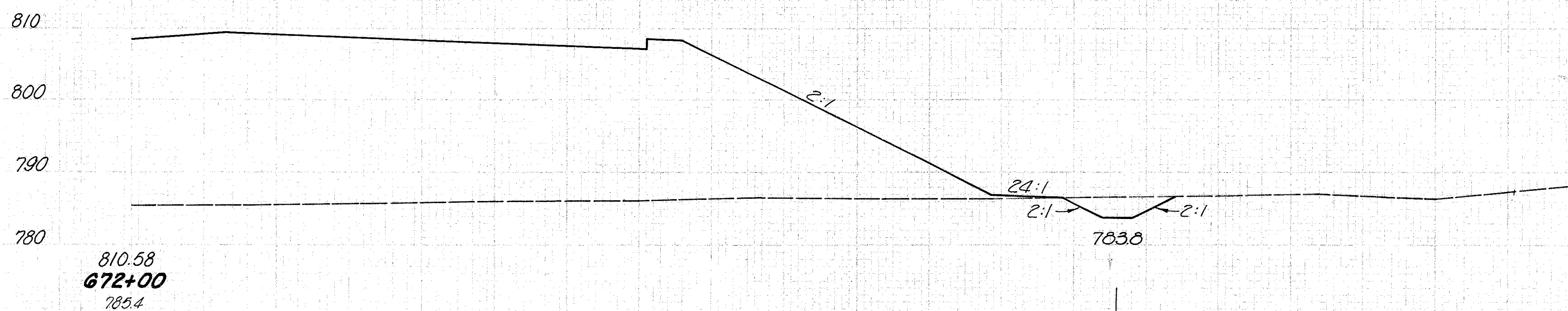

LT 0 2670  
RT 31 2220

0 50 100 150 200 STA 671+00 34 4424

I-71 X-SEC. ~ STA. 672+00 TO STA. 674+00 RIGHT



CUYAHOGA COUNTY  
CUY-71-10.44  
CO. RD. No. 129

116  
665

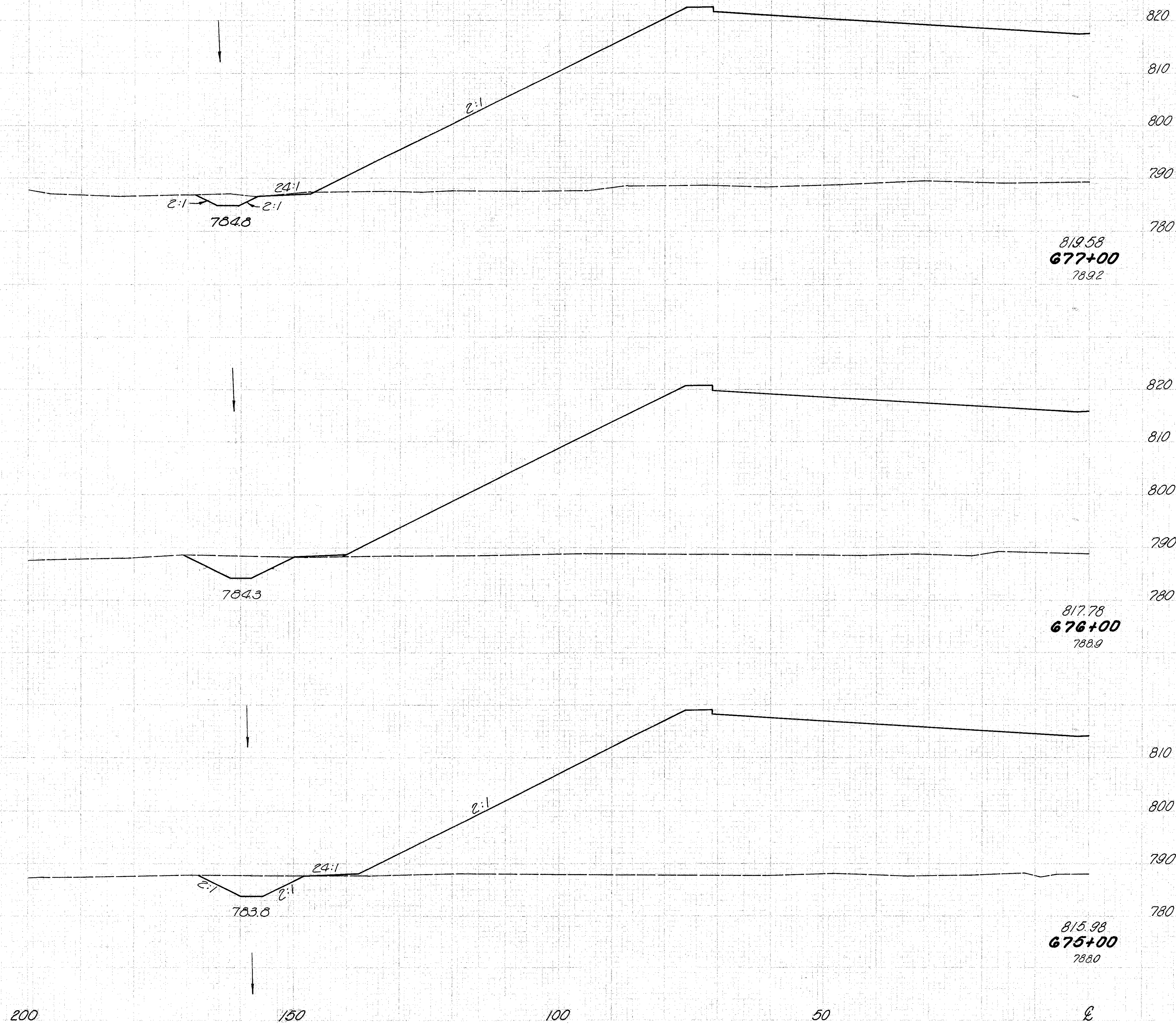

I-71 X-SEC. ~ STA. 675+00 TO STA. 677+00 LEFT

DESCRIPTION	PLANNED	CALCULATED	CHECKED
ORIGINAL GROUND	DATE	DATE	DATE
BRIDGE	01/10/73		
END AREA			
SECTION AREA			
SECTION AREA			

CUYAHOGA COUNTY  
CUY-71-10.44  
CO. RD. No. 189

STATION	DATE	BY	CHKD.
14	3355		
12	2850		
28	6403		

14 3355  
12 2850  
28 6403

183 22,760

LT. 53 3245  
RT. 18 2640  
71 5885

272 21,306

52 3130  
24 2490  
76 5220

261 20,276

65 5329

819.58  
677+00  
789.2

817.78  
676+00  
788.9

815.98  
675+00  
788.0

2:1

24:1  
2:1  
786.8  
2:1

786.1

2:1

24:1  
2:1  
785.4  
2:1

I-71 X-SEC. ~ STA. 675+00 TO STA. 677+00 RIGHT



CUYAHOGA COUNTY  
CUY-71-10.44  
CO. RD. No. 189

DATE	BY	CHECKED

118  
665

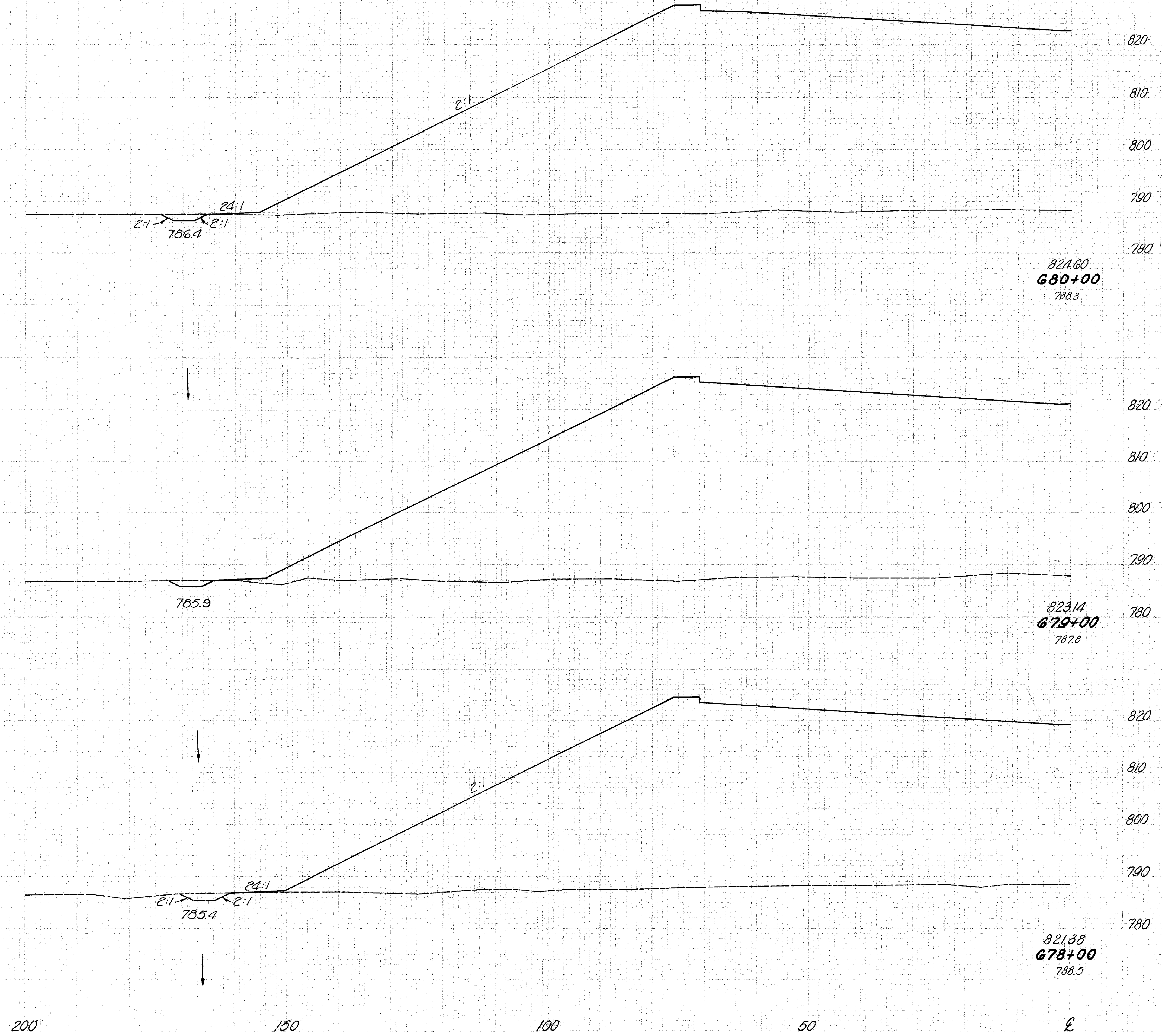

7 4330

7 4270

12 3920

200 150 100 50 0

I-71 X-SEC. ~ STA. 678+00 TO STA. 680+00 LEFT

DESCRIPTION	DATE	BY	CHECKED
ORIGINAL GROUND	03/80		
PROPOSED EMBANKMENT	03/80		
EXISTING GRADE	03/80		
PROPOSED GRADE	03/80		
EXISTING AREA	03/80		
PROPOSED AREA	03/80		

CUYAHOGA COUNTY  
CUY-71-10.44  
CO. RD. No. 189

姓名: 王明 性别: 男 年龄: 25 职业: 教师

LT	7	4390
RT	0	1998
	7	4388

26 25,131

LT.	7	4270
RT.	0	2912
	7	7182

35 26,226

LT.	12	3920
RT.	0	3060
	<u>12</u>	<u>6980</u>

74 24,788

28 6405

I-71 X-SEC. ~ STA. 678+00 TO STA. 680+00 RIGHT

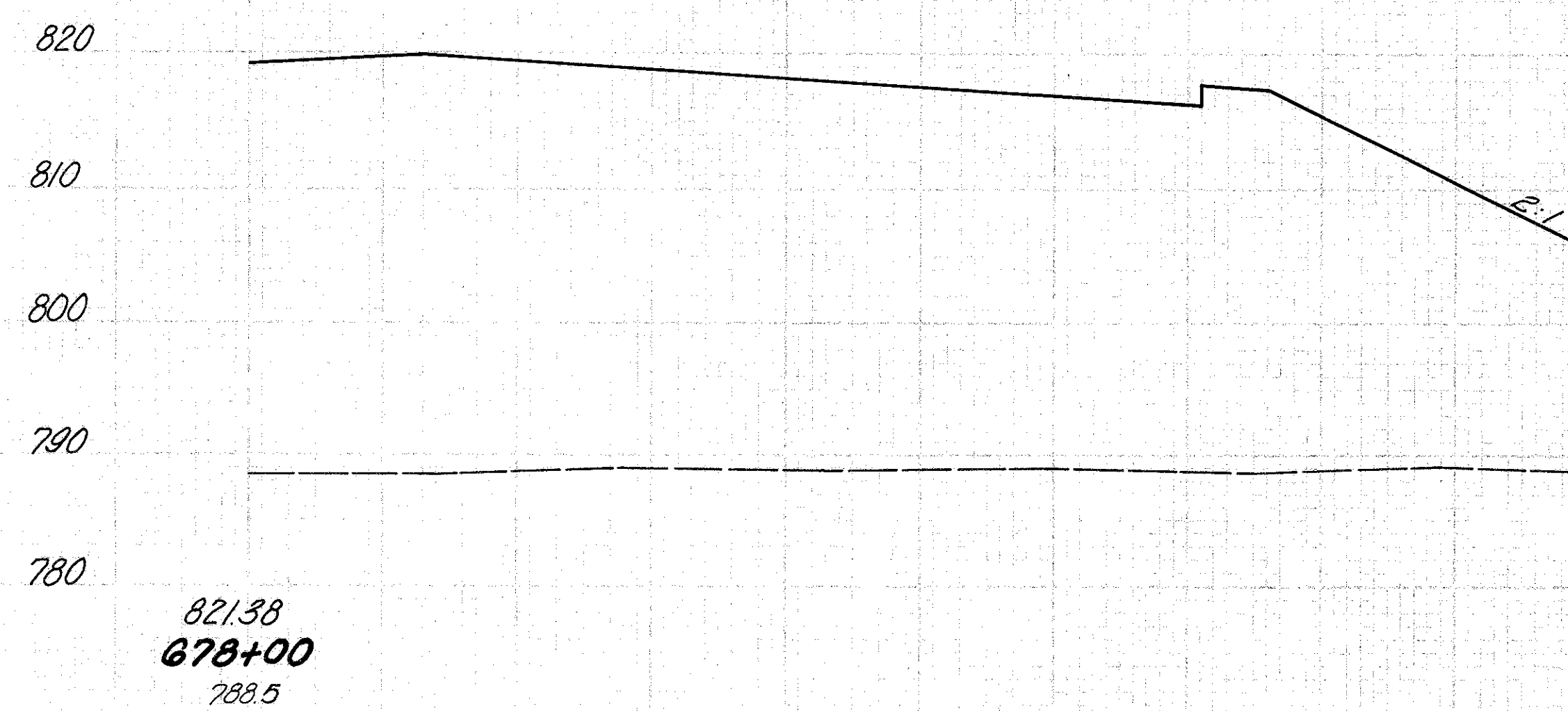
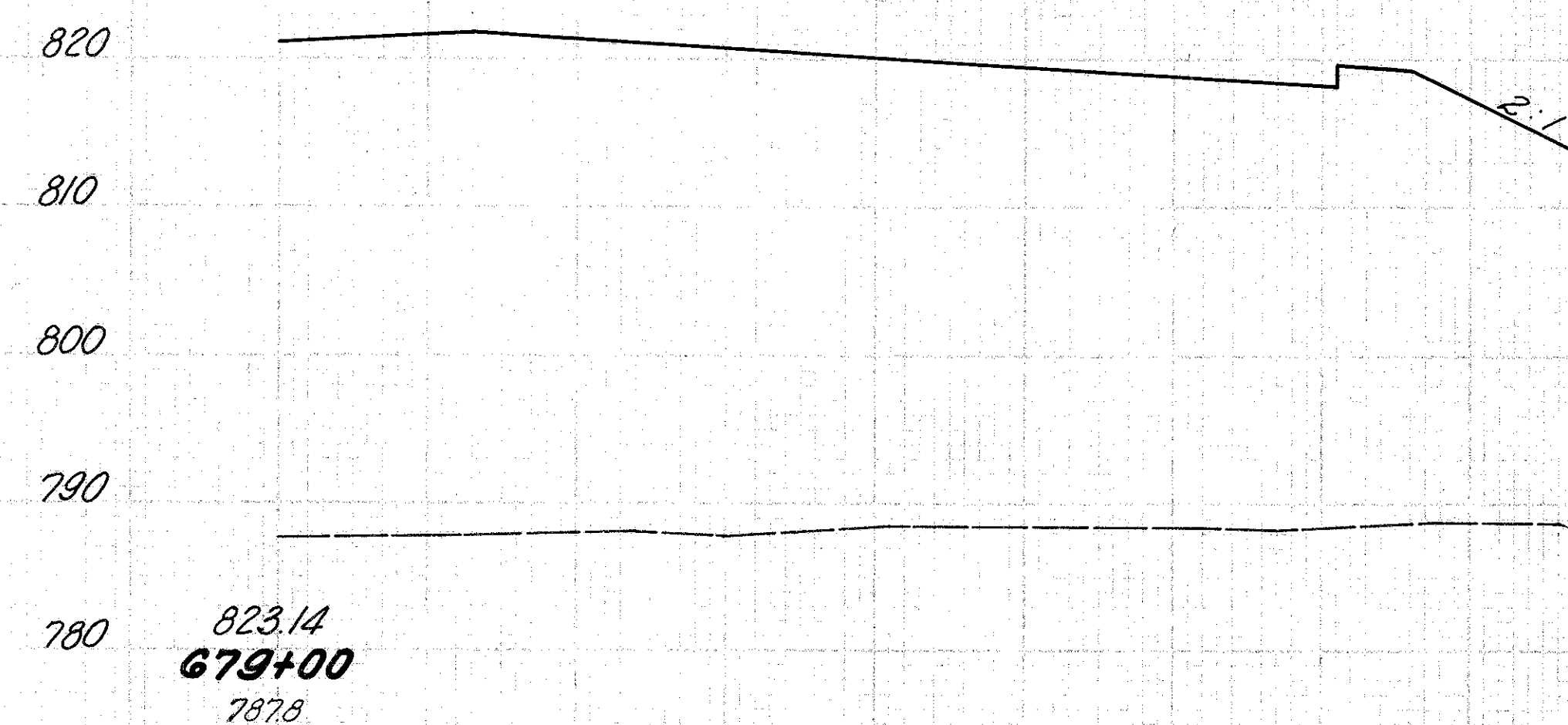
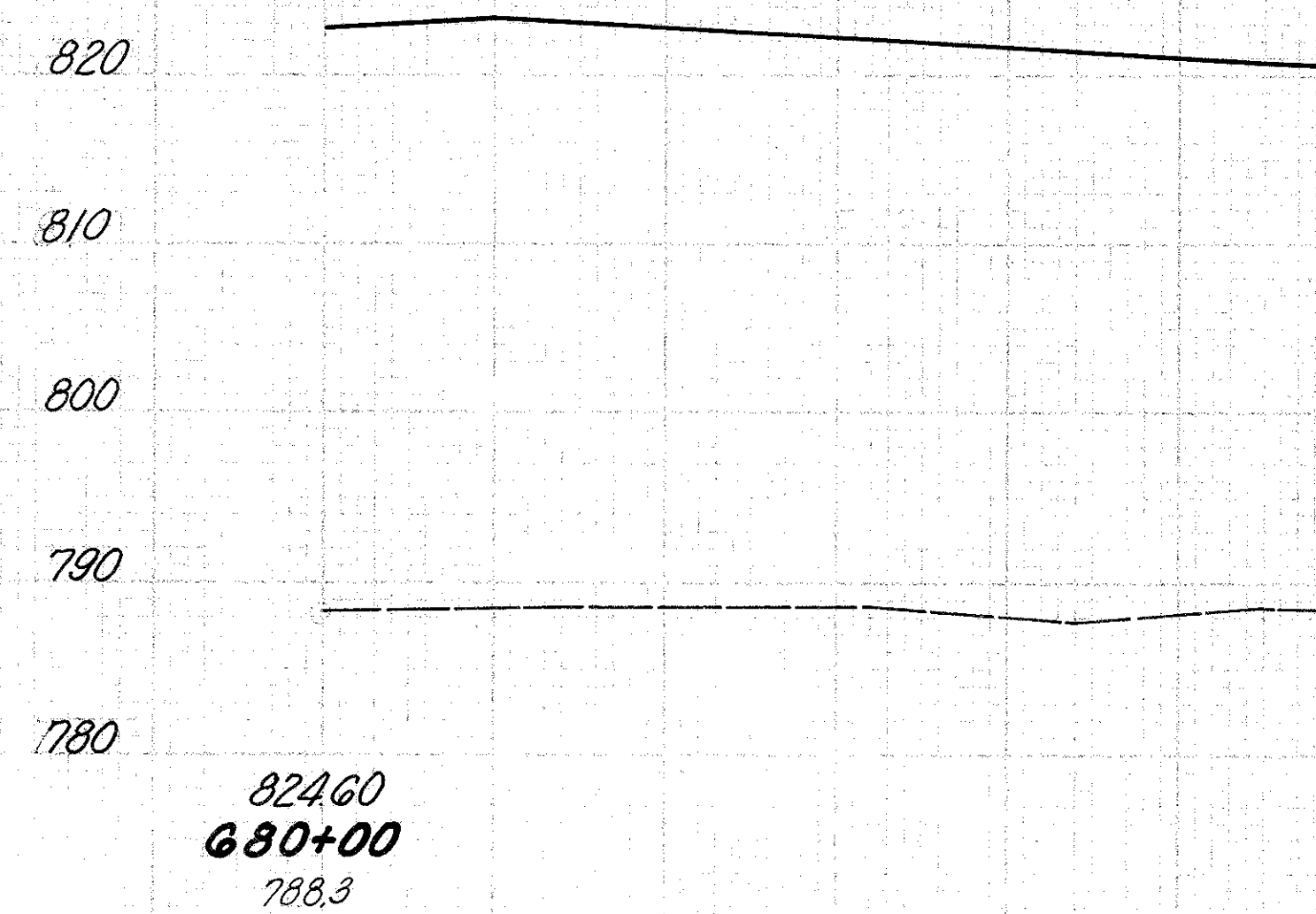



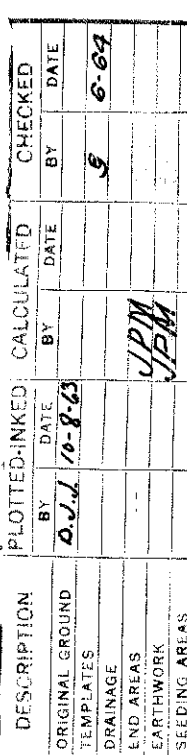



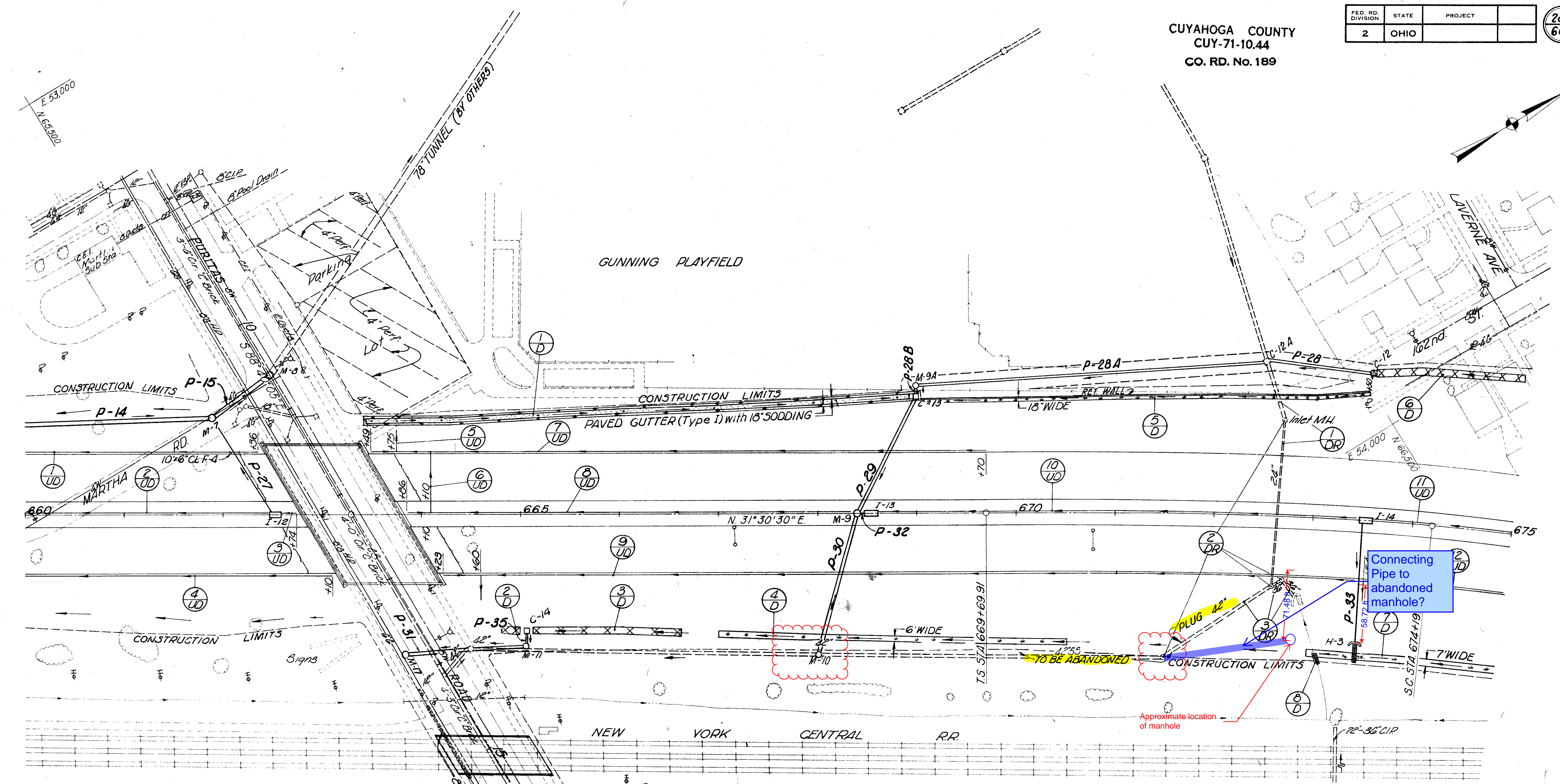

Connecting  
Pipe to  
abandoned  
manhole?

Approximate location  
of manhole

ESTIMATED QUANTITIES

REF. STATION TO STATION SIDE	I-1 PIPE				I-5 PIPE S.P.			
	Class F-4		Class I-3		6" CI. I-3		6" CI. I-1	
	8" Sec. M-646		SHALLOW		6"		BEND 90°	
	LIN. FT.	SEC.	LIN. FT.	SEC.	LIN. FT.	SEC.	TEE	CROSS
1-UD 660+00 to 662+36	LT.	10	226					
2-UD 660+00 to 662+46	E.		246					
3-UD 662+50 to 662+74	E.	10	14					
4-UD 660+00 to 663+10	RT.		310					
5-UD 663+75	LT.	10	13					
6-UD 664+10	LT.				61			
7-UD 663+49 to 669+70	LT.		621				1	1
8-UD 663+86 to 663+36	E.		450					
9-UD 664+23 to 673+46	RT.	10	938				1	1
10-UD 668+50 to 673+46	E.	10	486					
11-UD 673+50 to 675+00	E.		190					
12-UD 673+54 to 675+00	RT.	10	157					
SUB-TOTAL							1	2
TOTALS	30	30	3601	61			3	2

NOTE:  
FOR DRAINAGE PROFILES  
SEE SHEET NO. 303 & 304.  
  
X  
FOR PURITAS ROAD DRAINAGE  
PLANS - SEE SHEET NOS. 213 to 218

ESTIMATED QUANTITIES

REF. STATION TO STATION SIDE	I-12 PIPE						
	E-12		I-14		I-10		I-16
	PIPE REMOVE 15" & OVER		PAVED GUTTER TYPE-1		DUMPED ROCK CHANNEL PROTECT.		MANHOLE ABANDON.
	LIN. FT.	SEC.	LIN. FT.	SEC.	CU. YD.	EACH	SQ. YD.
1-D 663+45 to 663+93	LT.						
2-D 664+85 to 665+03	RT.						
3-D 665+17 to 666+67	RT.						
4-D 667+00 to 670+50	RT.						234
5-D 669+00 to 673+50	LT.						75
6-D 672+64 to 673+14	LT.						125
7-D 673+50 to 675+00	RT.						156
8-D 675+12	RT.						
1-DR 672+57 to 672+67	E.	200			2.2		
2-DR 671+42 to 672+72	E.					4	
3-DR 671+67 to 672+85	RT.	140					
TOTALS	340	540	2.2	4	653	267	



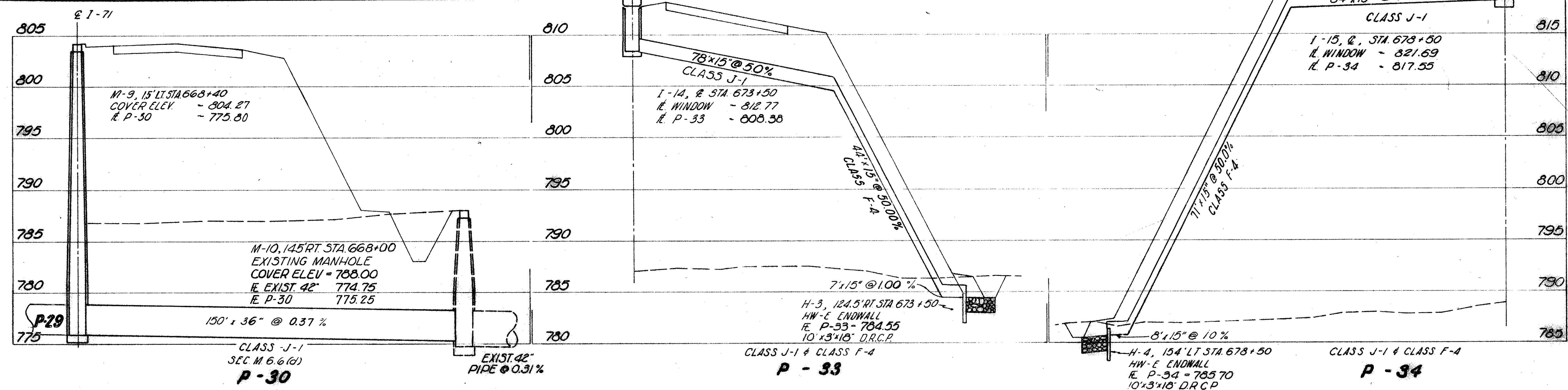
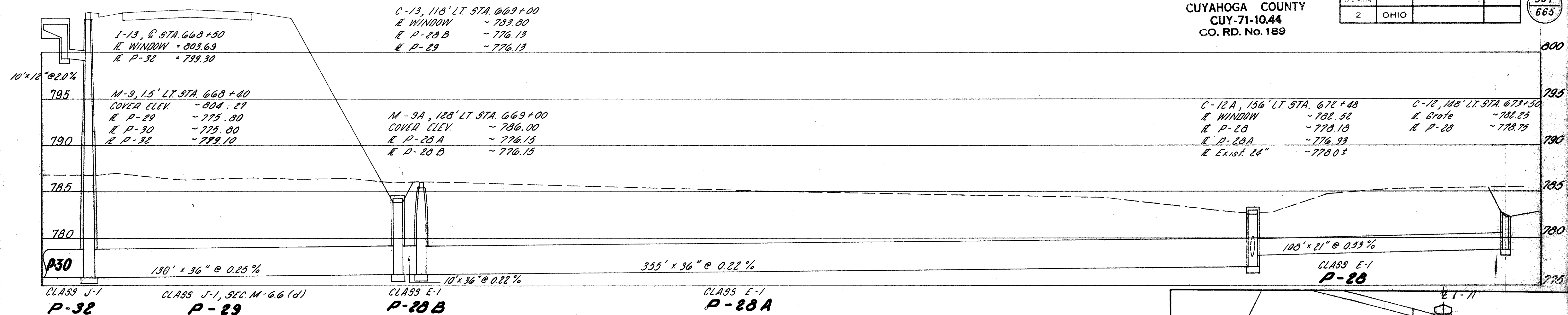

ESTIMATED QUANTITIES																				SEE SHEET NO.			
PIPE REFERENCE	STRUCTURES INCLUDED		I-1				I-2	I-5	I-6				I-10	L-10									
			CL. J-1	CL. E-1		CLASS F-4			CLASS J-1		PIPE 3000 CL. F-4 15" 30° BENDS	INLETS SPECIAL				STD. No. 2-4 C.B.	STD. No. 5 C.B.	STD. No. 1 M.H.	STD. No. 2 M.H.		DUMPED ROCK CHANNEL PROTECTION C.Y.	SODDING	
				12" L.F.	21" L.F.				36" L.F.	15" L.F.		15" L.F.											36" L.F.
P-28	C-12																						
P-29	C-13			108																			
P-30	M-9, M-10																						
P-32	I-13																						
P-33	I-14 & H-3																						
P-34	I-15 & H-4																						
P-28 A	C-12 A																						
P-28 B	M-9 A																						

FOR DRAINAGE PLAN -  
SEE SHEET NO 288 & 289



FED. RD. DIVISION	STATE	PROJECT	
2	OHIO		

648  
665

20  
37





# CONCRETE BARRIER MEDIAN DETAILS

1978

FHWA REGION	STATE	PROJECT
5	OHIO	

39  
155

CUYAHOGA COUNTY  
CUY.-71-9.96

## QUANTITY CALCULATIONS

MADE BY G.F.M. DATE 8-15-75  
CHECKED BY D.S.P. DATE 9-10-75

CENTERLINE REFERENCE MONUMENT, MODIFIED AS PER PLAN COST PART. II		
STATION	604	
	Ref Monument Mod. As Per Plan	
	Each	
Airport Freeway		
S.C. Sta. 615+88.80	1	
C.S. Sta. 620+49.91	1	
S.T. Sta. 623+99.91	1	
Interstate 71		
P.C. Sta. 631+61.88	1	
P.O.C. Sta. 635+00.00	1	
P.T. Sta. 639+79.02	1	
P.O.T. Sta. 645+00.00	1	
P.O.T. Sta. 650+00.00	1	
P.O.T. Sta. 655+00.00	1	
P.O.T. Sta. 660+00.00	1	
P.O.T. Sta. 665+00.00	1	
T.S. Sta. 669+69.91	1	
S.C. Sta. 674+19.91	1	
P.O.C. Sta. 680+00.00	1	
P.O.C. Sta. 685+00.00	1	
P.O.C. Sta. 690+00.00	1	
C.S. Sta. 694+18.69	1	
S.T. Sta. 698+68.69	1	
P.O.T. Sta. 705+00.00	1	
P.O.T. Sta. 710+00.00	1	
P.O.T. Sta. 715+00.00	1	
T.S. Sta. 719+30.30	1	
S.C. Sta. 723+80.30	1	
P.O.C. Sta. 730+00.00	1	
C.S. Sta. 737+28.97	1	
S.T. Sta. 741+78.97	1	
P.O.T. Sta. 745+00.00	1	
P.O.T. Sta. 750+00.00	1	
P.O.T. Sta. 755+00.00	1	
T.S. Sta. 757+85.47	1	
S.C. Sta. 763+35.47	1	
P.O.C. Sta. 768+00.00	1	
C.S. Sta. 772+30.47	1	
S.T. Sta. 777+80.47	1	
P.O.T. Sta. 780+00.00	1	
P.O.T. Sta. 785+00.00	1	
P.O.T. Sta. 790+00.00	1	
P.C. Sta. 792+77.14	1	
TOTAL	39	

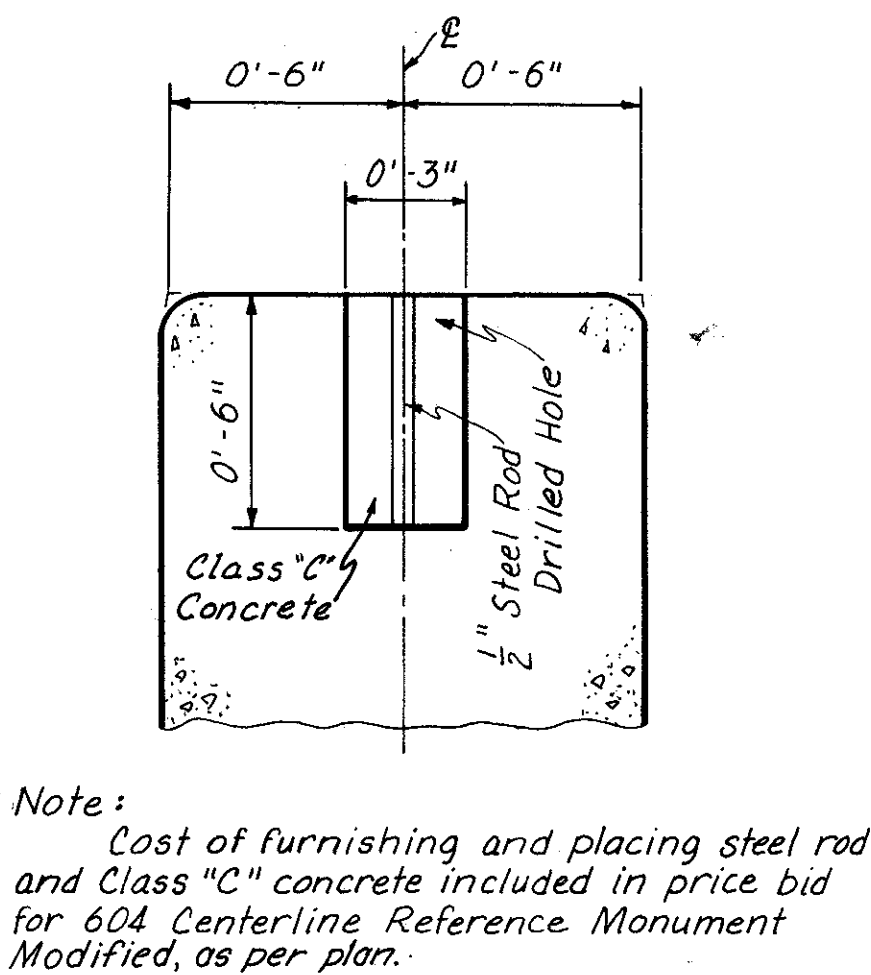

CENTERLINE REFERENCE  
MONUMENT MODIFIED, AS PER PLAN  
No Scale

LIMITING STATIONS OF 36" TOP WIDTH MEDIAN BARRIER	
FROM	TO
633+92	634+02
649+40	649+50
691+20	691+30
739+60	739+70
754+34	754+44
774+45	774+55
777+65	777+75
780+85	780+95
784+05	784+15
787+25	787+35
793+65	793+75
839+87	839+97
858+95	859+05

# MULTIPLE BARRIER TRANSITIONS									
TOP WIDTH	BEGIN TRANS.	END TRANS.	TOP WIDTH	BEGIN TRANS.	END TRANS.	TOP WIDTH	BEGIN TRANS.	END TRANS.	TOP WIDTH
12"	789+20	789+40	24"	789+65	789+85	36"	790+55	790+95	12"
12"	808+04	808+64	48"	809+47	809+87	24"	810+10	810+30	12"

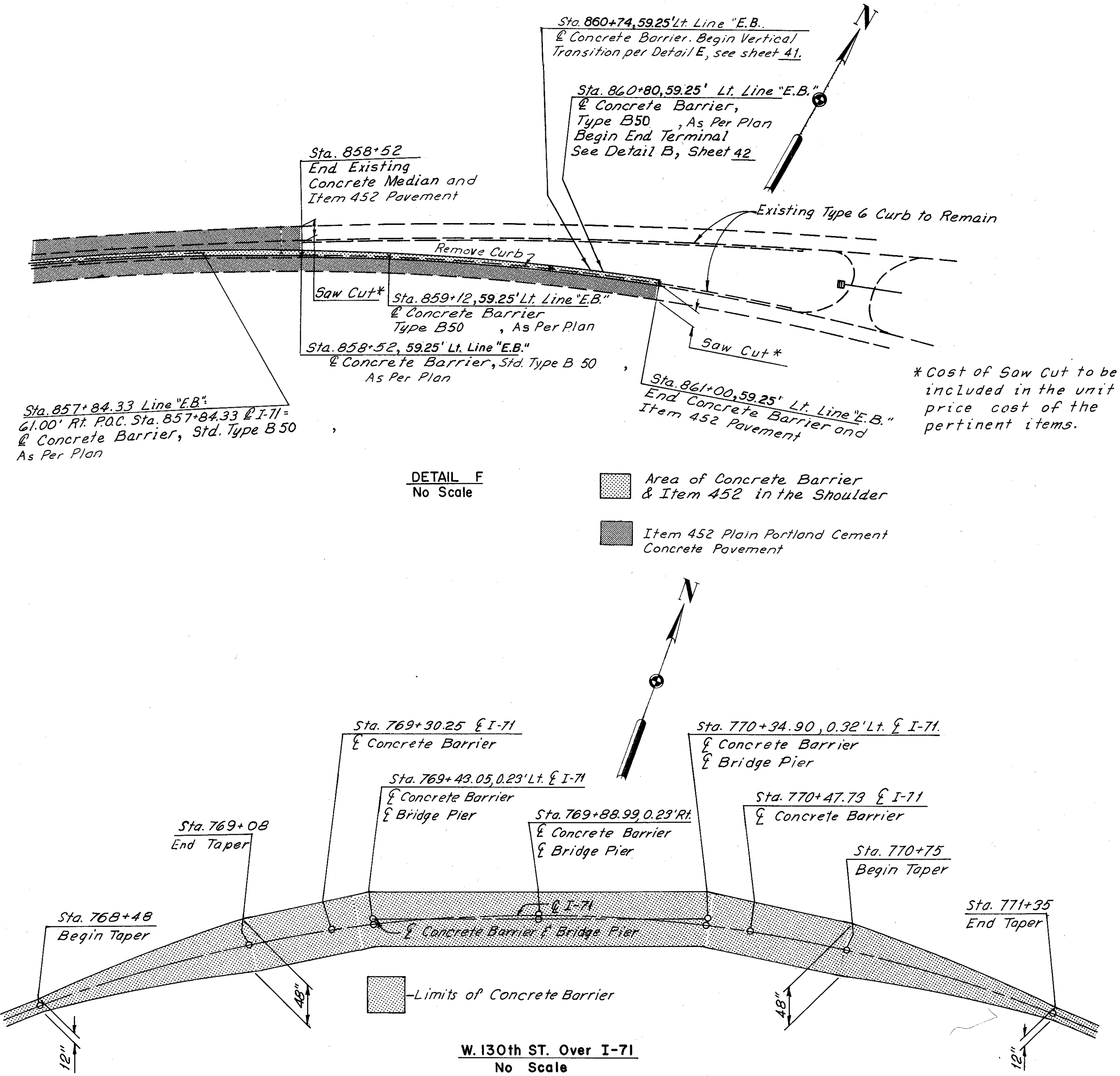





13002DSA.DGN

13002DSA.DGN

CALCULATED	<i>LGM</i>
CHECKED	<i>ENF</i>

CUYAHOGA COUNTY  
CUY-71-10.44

73B  
321



PLOTTED BY: lmincek

PLOTTED FROM: I:\users\ddougher\pdl\3002\13002dpc.dgn

13002DPC.DGN

PLOT SUBMITTED: 22-DEC-1997 10:00

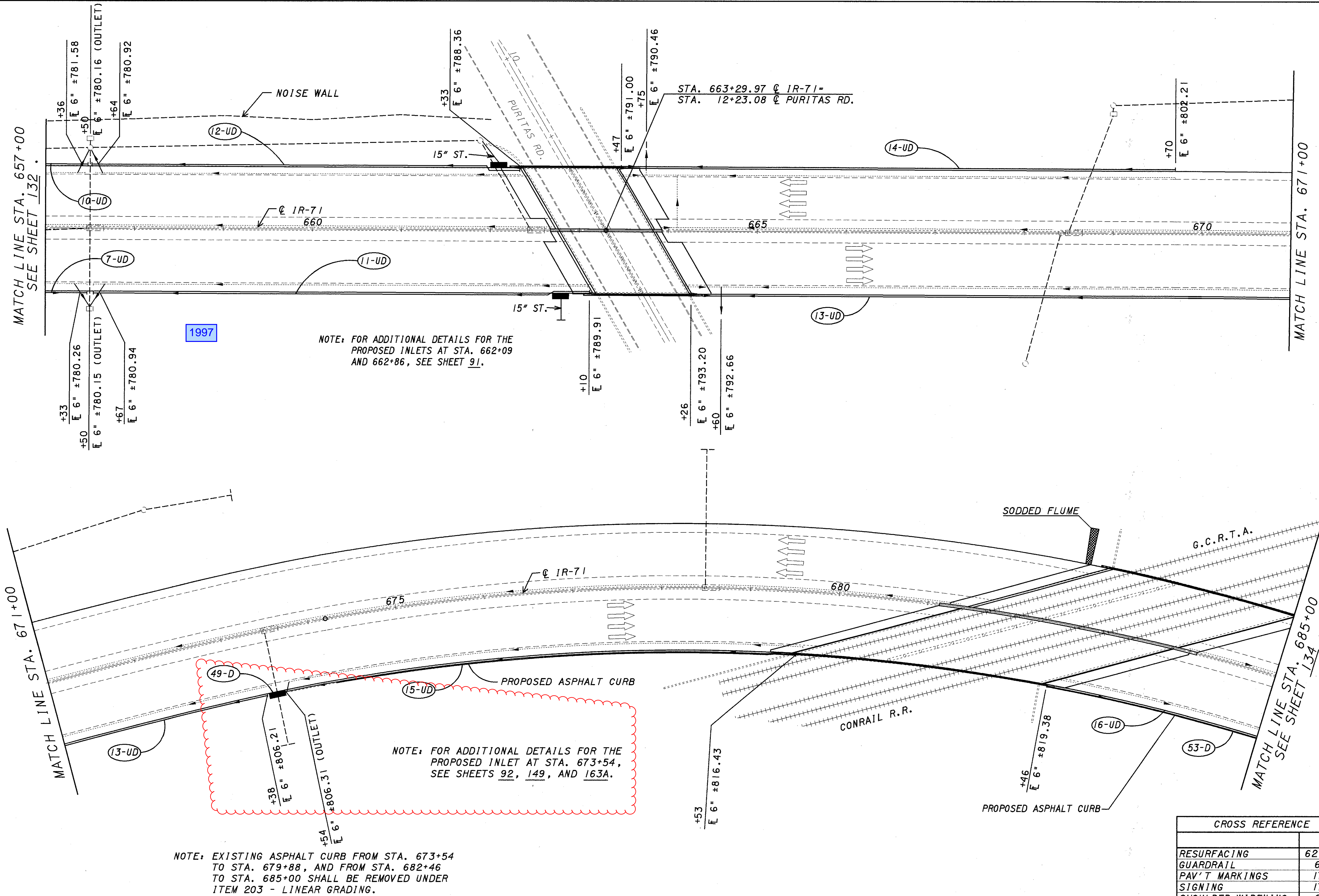

NOTE: EXISTING ASPHALT CURB FROM STA. 673+54 TO STA. 679+88, AND FROM STA. 682+46 TO STA. 685+00 SHALL BE REMOVED UNDER ITEM 203 - LINEAR GRADING.

NOTE: FOR ADDITIONAL DETAILS FOR THE PROPOSED INLETS AT STA. 662+09 AND 662+86, SEE SHEET 91.

NOTE: FOR ADDITIONAL DETAILS FOR THE PROPOSED INLET AT STA. 673+54, SEE SHEETS 92, 149, AND 163A.

CROSS REFERENCE	
RESURFACING	62,63
GUARDRAIL	65
PAV'T MARKINGS	179
SIGNING	179
SHOULDER WIDENING	62
PLAN SHEET	76
UNDERDRAIN QUANTITIES	72,73
DRAINAGE QUANTITIES	73A

CUYAHOGA COUNTY  
CUY-71-10.44

DRAINAGE PLAN SHEET  
IR-71  
STA. 657+00 TO STA. 685+00

133  
321

CALCULATED	FLK	REVIEWED
LGM		ENF

SCALE IN FEET  
0 50 100



PLOTTED BY: lmincek  
PLOTTED FROM: C:\Users\Bekallio\p11530\47xsect1.dgn  
47XSECT1.dgn  
PLOT SUBMITTED: 22-DEC-1997 15:25

SEEDING	
END WIDTH	SO. YDS.

1997

☐ OF R/W AND CONSTRUCTION

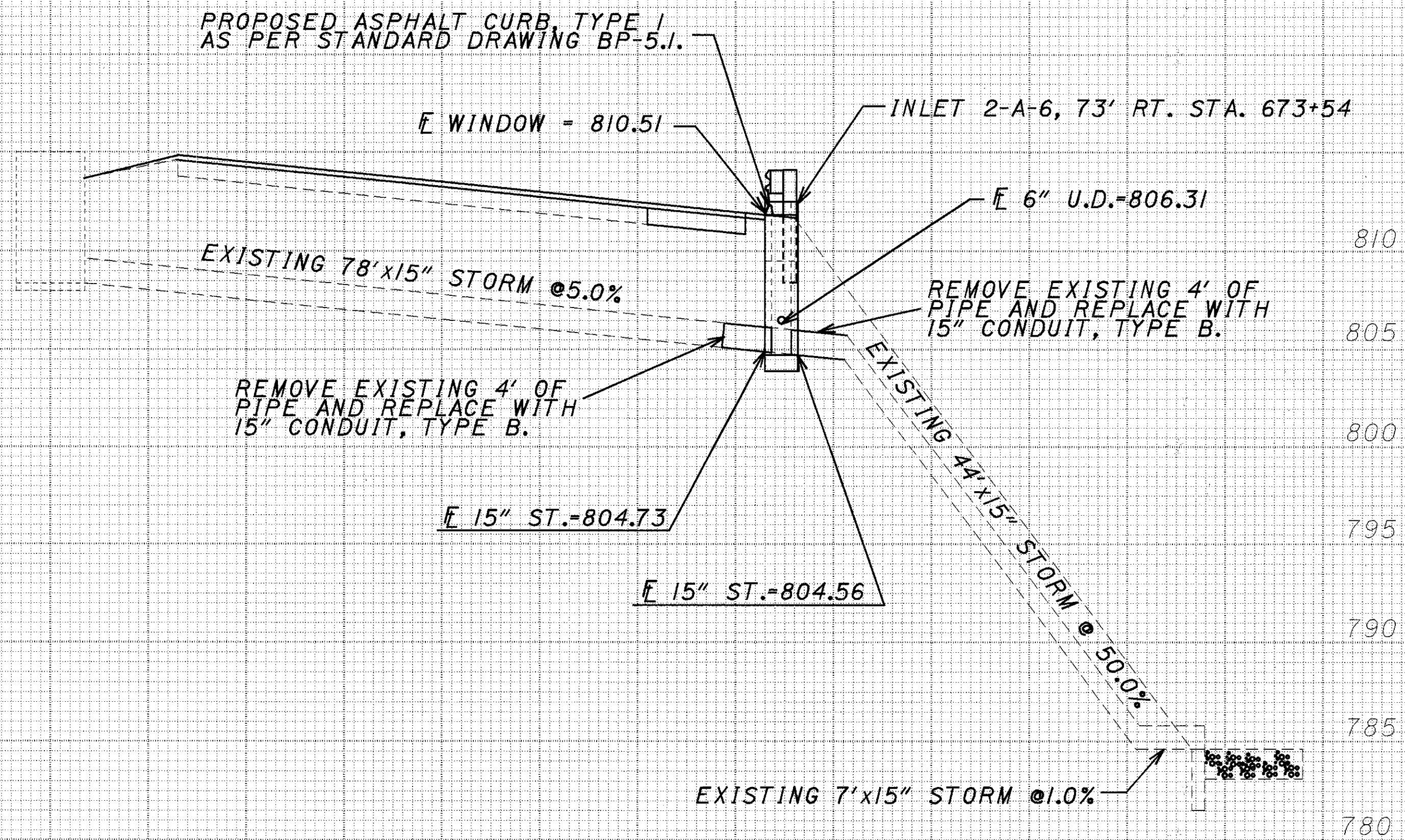

SEE DRAINAGE PLAN SHEET 133 FOR  
ADDITIONAL INFORMATION.  
SEE SHEET 73B FOR QUANTITIES.

END AREA		VOLUME		CALCULATED	CHECKED
CUT	FILL	CUT	FILL		
STORM SEWER PROFILES STA. 673+54					
CUI-71-10.44					
149 321					